



# The Chocolate Quarter

ST MONICA TRUST

## 18 River House

Large ground floor two bedroom apartment



Keynsham, Bristol BS31 2GG

**£515,000 leasehold**  
(other charges apply)



St Monica Trust



APPROVED  
OPERATOR



The Chocolate Quarter

ST MONICA TRUST

# I 8 River House

Keynsham, Bristol BS31 2GG



Private terrace

## Specification

- Ground floor apartment with a spacious private terrace
- Well presented throughout
- Large open plan dining/living/ kitchen
- Two bedrooms, one ensuite
- Separate laundry room
- Cloakroom
- Featuring high ceilings and large windows
- Repainted and replaced carpets in lounge and bedroom one
- Being sold on an equity participation lease



**Kitchen**



**Shower room**

## Fees for 2025 & EPC

Service charge £9,744 pa  
Council Tax Band E £2,841.80 pa  
Current EPC Band C (Rating 73)  
Potential EPC Band C (Rating 73)

## Viewing dates

Please call the sales team  
to book **0117 363 7160**

### Please note

this apartment is sold unfurnished and furniture in this floorplan is for reference only.

Dimensions shown are maximum. Some plots are handed compared to floorplans. Floorplans are not to scale and depict

typical layout of this apartment type. Certain particulars may vary, please check with our sales team.

A surrender fee is payable when the property is returned to the Trust (ranging from 2% to 10% of the purchase price

depending on the lease and length of occupation).

Neff cooker, Bosch fridge/freezer, dishwasher, washing machine and tumble dryer included.

Building converted in August 2017.



**The Chocolate Quarter**

ST MONICA TRUST

# I8 River House

Keynsham, Bristol BS31 2GG

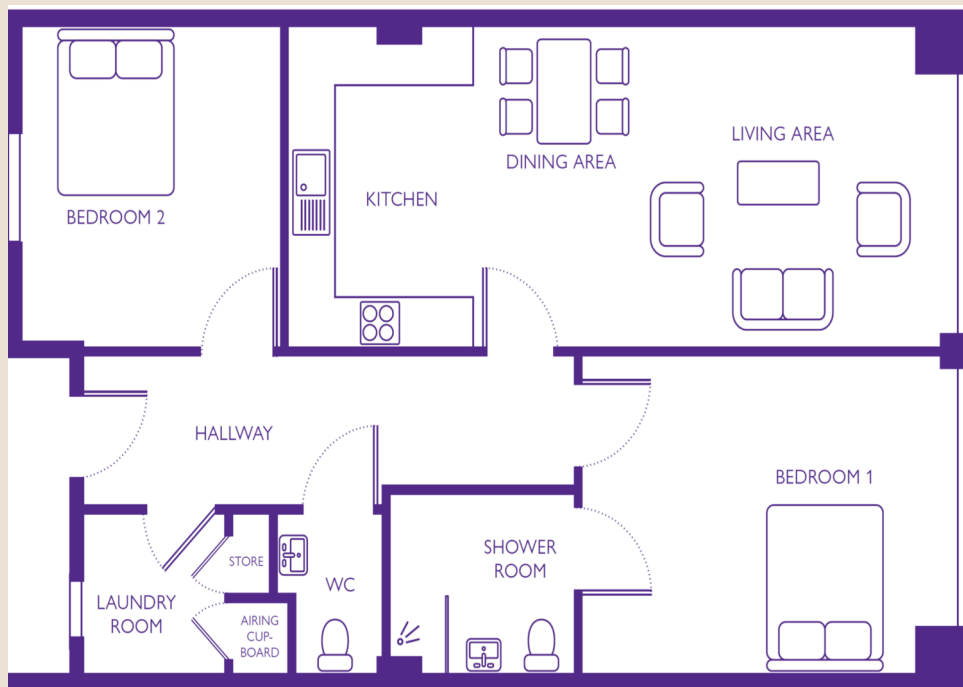

## Living room

8.7m x 3.6m

28'7" x 11'10"

## Shower room

2.5m x 2.0m

8'2" x 6'7"

## Bedroom 1

4.8m x 3.6m

15'9" x 11'10"

## Bedroom 2

3.6m x 3.6m

11'10" x 11'10"

To unsubscribe please telephone

**0117 949 4004** or email

**[sales.team@stmonicastrust.org.uk](mailto:sales.team@stmonicastrust.org.uk)**



St Monica Trust APPROVED  
OPERATOR

