



The Chocolate Quarter

ST MONICA TRUST

25 River House

Large two bed apartment near rooftop garden



Keynsham, Bristol BS31 2GH

£440,000 leasehold
(other charges apply)



St Monica Trust



APPROVED
OPERATOR



The Chocolate Quarter

ST MONICA TRUST

25 River House

Keynsham, Bristol BS31 2GH



Example living area

Specification

- First floor apartment
- Large open plan dining / lounge
- Two bedrooms, one ensuite
- Separate laundry room
- Cloakroom
- Featuring high ceilings and large picture windows
- Redecorated and new carpets
- Located close to lift and stairs
- Being sold on a fixed refund lease
- Photos for illustrative purposes only



Example Kitchen



Shower room

Fees

Two bed £9,424 pa
Council Tax Band E £2,697.30 pa
Current EPC Band B (Rating 81)
Potential EPC Band B (Rating 81)

Viewing dates

Please call the sales team to book
0117 949 4004

Please note

this apartment is sold unfurnished and furniture in this floorplan is for reference only.

Dimensions shown are maximum. Some plots are handed compared to floorplans. Floorplans are not to scale and depict

typical layout of this apartment type. Certain particulars may vary, please check with our sales team.

A surrender fee is payable when the property is returned to the Trust (ranging from 1% to 10% of the purchase price

depending on the lease and length of occupation).

Neff cooker, Bosch fridge/freezer, dishwasher, washing machine and tumble dryer included.

Building converted in August 2017.



The Chocolate Quarter

ST MONICA TRUST

25 River House

Keynsham, Bristol BS31 2GH

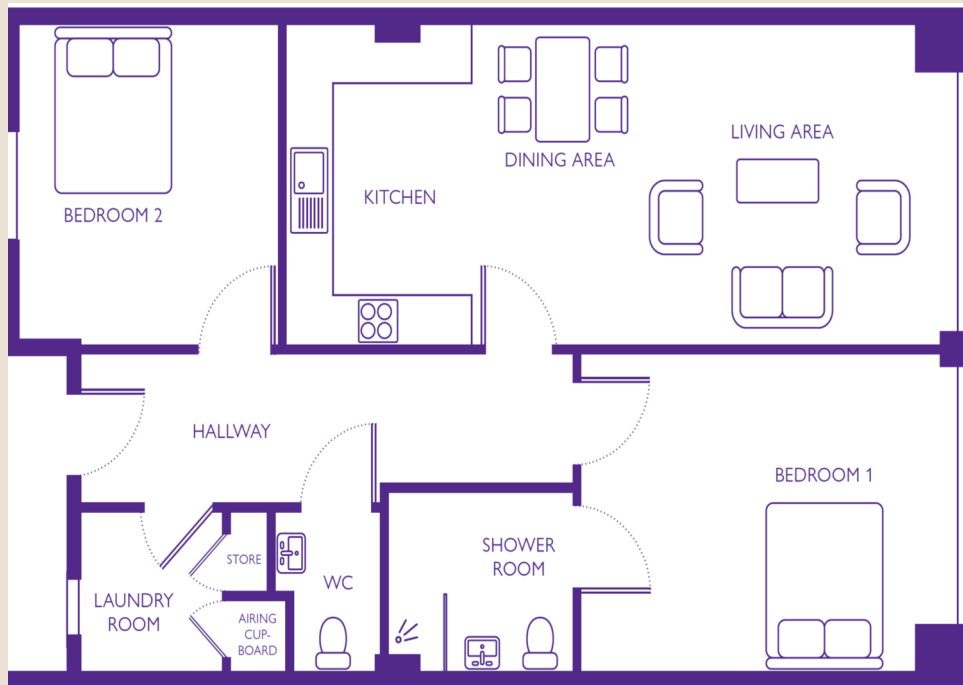

Living room/ kitchen

8.7m x 3.6m

28'7" x 11'10"

Shower room

2.5m x 2.0m

8'2" x 6'7"

Bedroom 1

4.8m x 3.6m

15'9" x 11'10"

Bedroom 2

3.6m x 3.6m

11'10" x 11'10"

To unsubscribe please telephone

0117 949 4004 or email

sales.team@stmonicatrust.org.uk



St Monica Trust APPROVED OPERATOR