



The Chocolate Quarter

ST MONICA TRUST

3 Brookmead

Large two bed, two shower room apartment



Keynsham, Bristol BS31 2GJ

£15,000 Leasehold
(other charges apply)



St Monica Trust



APPROVED
OPERATOR



The Chocolate Quarter

ST MONICA TRUST

3 Brookmead

Keynsham, Bristol BS31 2GJ



View from communal terrace

Specification

- Spacious two double bedroom fourth floor apartment
- Large open plan living /dining/ kitchen area
- Two shower rooms, one ensuite
- No onward chain
- Located next to communal terrace
- Onsite facilities include cinema, art and pottery studio, two restaurants, swimming pool, hairdressers and barbers
- Being sold on an equity participation lease



Typical kitchen



Typical ensuite shower room

Fees for 2024

Two bed - £9,424 pa
Council Tax Band E £2,697.30 pa
Current EPC Band C (Rating 80)
Potential EPC Band C (Rating 80)

Viewings

Please call the sales team
to book **0117 949 4004**

Please note

this apartment is sold unfurnished and furniture in this floorplan is for reference only.

Dimensions shown are maximum. Some plots are handed compared to floorplans. Floorplans

are not to scale and depict typical layout of this apartment type. Certain particulars may vary, please check with our sales team.

A surrender fee is payable when the property is returned to the Trust (ranging from 2% to 10%

of the purchase price depending on the lease and length of occupation).

Neff cooker, Bosch fridge/freezer, dishwasher, washing machine and tumble dryer included.

Building converted in August 2017.



The Chocolate Quarter

ST MONICA TRUST

3 Brookmead

Keynsham, Bristol BS31 2GJ

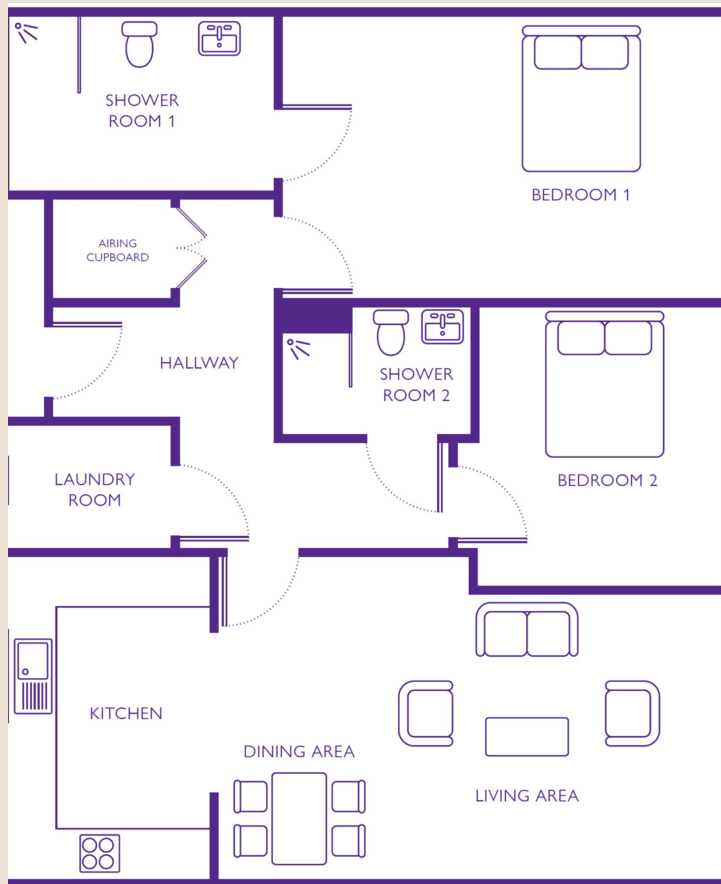

Kitchen/dining/ living area

9.2m x 4.1m

30'2" x 13'5"

Laundry

2.1m x 1.5m

6'11" x 4'11"

Bedroom 1

5.7m x 3.6m

18'8" x 11'10"

Bedroom 2

3.4m x 3.7m

11'2" x 12'2"

To unsubscribe please telephone
0117 949 4004 or email
sales.team@stmonicatrust.org.uk



St Monica Trust APPROVED
OPERATOR

