

Westbury Fields retirement community

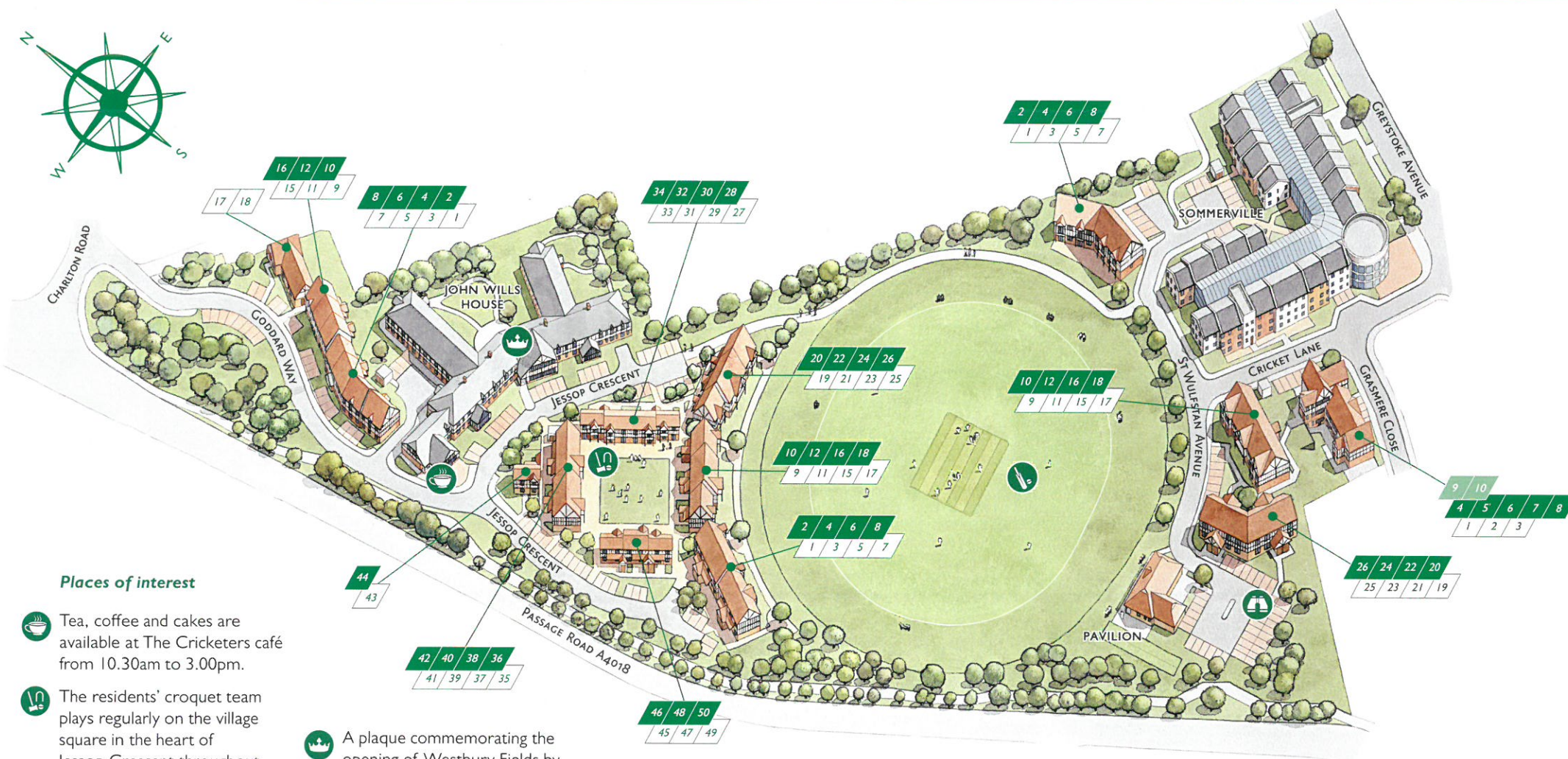

St Monica Trust



Places of interest



Tea, coffee and cakes are available at The Cricketers café from 10.30am to 3.00pm.



The residents' croquet team plays regularly on the village square in the heart of Jessop Crescent throughout the summer.



Cricket has been played at Westbury Fields since 1935 – first by Westbury-on-Trym Cricket Club and more recently by Bishopston Cricket Club.



A plaque commemorating the opening of Westbury Fields by Princess Anne in 2005 can be found in the reception area at John Wills House.



There is a viewing point in the car park behind the cricket pavilion which has lovely views across the surrounding area.



Second floor
First floor
Ground floor

All buildings are numbered front facing, from left to right

For illustrative purposes only, individual gardens, patios, parking areas and tree locations may vary

Westbury Fields retirement community

Home to more than 200 people, this unique development offers a range of accommodation together with care and support in a stimulating, vibrant and safe community.

Contact information

John Wills House **0117 377 3730**

Sommerville **0117 377 3700**

Porters **0117 377 3746**

Sales team **0117 949 4004**

info@stmonicastrust.org.uk

www.stmonicastrust.org.uk

HOW TO FIND US

There are two entrances, one on Cricket Lane and one on Goddard Way.

By car

From the city centre: proceed along the A4018 (Westbury Road, which will become Falcondale Road). **For the Cricket Lane entrance:** please take the first right after the Henbury Road traffic lights onto Greystoke Avenue. Cricket Lane is then the first turning on your left. **For the Goddard Way entrance:** continue on the A4018 and turn right onto Charlton Road just before the pedestrian crossing. The Goddard Way entrance to Westbury Fields will be on your immediate right.

From junction 17 of the M5 motorway: take the A4018. **For the Goddard Way entrance:** turn left

onto Charlton Road and the entrance will be on your right. **For the Cricket Lane entrance:** continue down the hill and take the first left onto Greystoke Avenue. Cricket Lane is then the first turning on your left.

Sat Nav

For the Cricket Lane entrance: enter the postcode BS10 6TW into your sat nav. **For the Goddard Way entrance:** enter BS10 6TU into your sat nav.

Parking

Parking for the Cricket Lane entrance is behind the cricket pavilion off St Wulfstan Avenue. Parking for the Goddard Way entrance is along Goddard Way. Please note that access between the Cricket Lane end of the site and the Goddard Way end is by a pedestrian walkway only.

By train

The nearest railway station is Clifton Down railway station off Whiteladies Road, just over 3 miles from Westbury Fields. Trains run from all parts of the UK into **Bristol Temple Meads** in the city centre (5 miles away) and to **Bristol Parkway** to the north of the city (4.5 miles away).

By bus

For the Goddard Way entrance: the number **1** bus stops on Charlton Road. **For the Cricket Lane entrance:** the number **2** bus stops at Greystoke Avenue and the number **20** stops at the Greystoke Avenue junction on Falcondale Road.

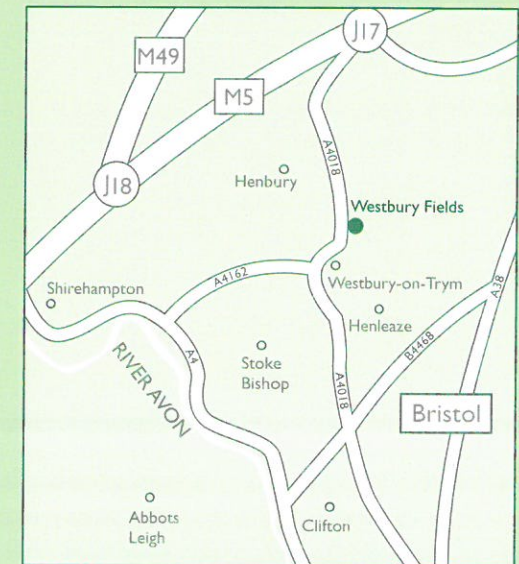

St Monica Trust
Delivering well-being



www.stmonicastrust.org.uk

Registered charity 202151 | 7/17 | 1,000